



# INSTRUCTIONS: POPPUF

## Puzzle Piece Floor Display

### Includes:

- A. Spinner Base (1)
- B. Side Panel Connector (1)
- C. Reinforcement Panels (2)
- D. Side Panels (2)
- E. Pegboards (2)
- F. Topper (1)
- G. Shelf (16)
- H. 6" Hooks (16)
- I. Cross Dowels (8)
- J. Bolts (8)
- K. Allen Wrench (1)

### Notes:

- Two person assembly
- Suggested tool: Flat Head Screwdriver



19"W x 62"H

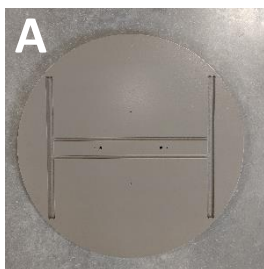

**Spinner Base**



**Side Panel Connector**

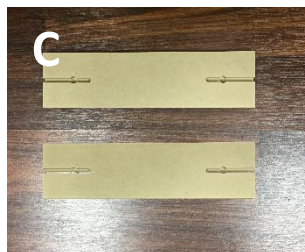

**Reinforcement Panels**

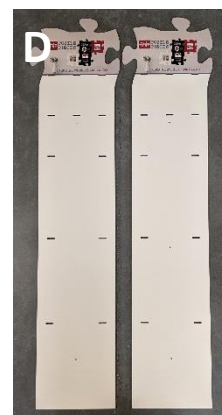

**Side Panels**

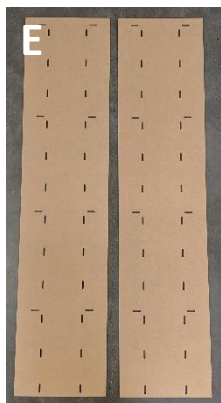

**Pegboards**



**Topper**

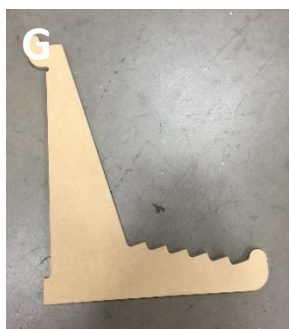

**Shelf**



**6" Hooks**



**Bolts**



**Cross Dowels**



**Allen Wrench**

1. Stand one Side Panel (D) upside down on floor.

**Note:** Due to uneven top of Side Panel (D) this will require two people.

2. Insert a Cross Dowel (I) into each circle opening in the Side Panel Connector (B). Assure the slits in the Cross Dowels (I) are parallel with the Side Panel Connector (B) openings, using a Flat Head Screw Driver.

3. Place Side Panel Connector (B) upside down aligning tabs on Side Panel Connector (B) with slots on Side Panel (D). From the side, place Bolts (J) in pre-drilled holes, then use Allen Wrench (K) to tighten.

**Note:** If assembled correctly, Bolts (J) will interlock with Cross Dowels (I) for stability.

4. Insert a Cross Dowel (I) into each circle opening in the Reinforcement Panels (C). Assure the slit in the Cross Dowel (I) is parallel with the Reinforcement Panel (C) openings using a Flat Head Screw Driver.

5. Line up the Reinforcement Panel (C) with the pre- drilled hole on the inside of the Side Panel (D). From the side, place Bolts (J) in pre- drilled holes then use Allen Wrench (K) to tighten. Repeat this for both Reinforcement Panels (C).

6. Repeat Steps 3-5 for second Side Panel (D).

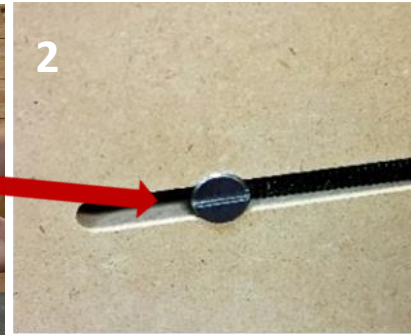
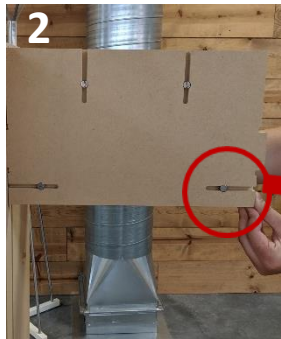

7. Place Spinner Base (A), painted side down, on top of Side Panels (F) by aligning slots.



8. Rotate bottom of Spinner Base (A) until pre-drilled holes are accessible. Place Bolts (D) in pre-drilled holes, then use Allen Wrench (E) to tighten.

**Note:** If assembled correctly, Bolts (D) will interlock with Cross Dowels (C) for stability.

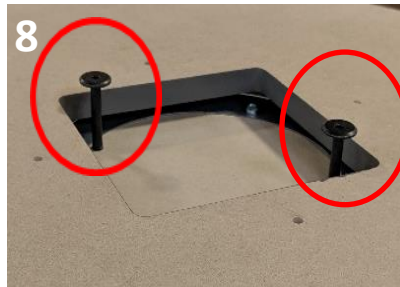

9. Carefully turn display right side up again.

**Note:** This may require two people to flip.

10. Slide Pegboards (E) into the slots on the Side Panels (D).

**Note:** The top of the Pegboard (E) has the horizontal slots closest to the edge. At first, decorative puzzle tab at top may seem in the way. Simply spread Side Panels (D) slightly to access slots. Display may need to be tilted for stores with lower ceilings to slide into place.

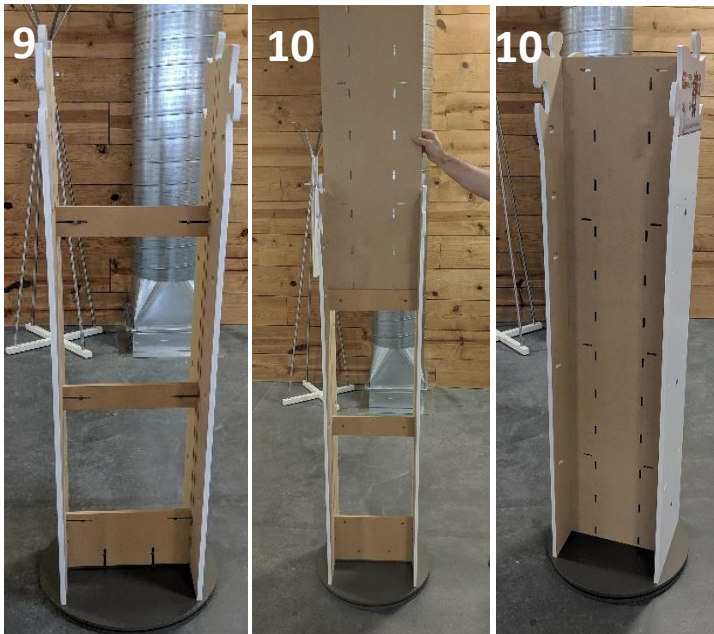

11. The Pegboards (E) should be level with the tops of the Side Panels (D). If they are not level, lightly tap or wiggle the bottoms of the Pegboards (E) until they slide into place.



12. Place Topper (F) on top of the Side Panels (D).

**Note:** This should go on easily if lined up with Pegboards (E) properly.

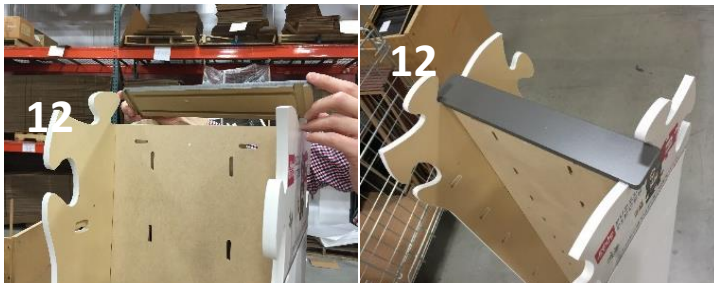



13. Place Shelves (G) on Pegboards (E) starting at the top vertical slot and working down.)



14. Place 6" Hooks (H) on Side Panels (D) starting at the top horizontal slot and working down (skipping second row and middle slots).



15. Congratulations! Display is ready to load with product.



## Puzzle Pieces



POPPUF-PUF8